

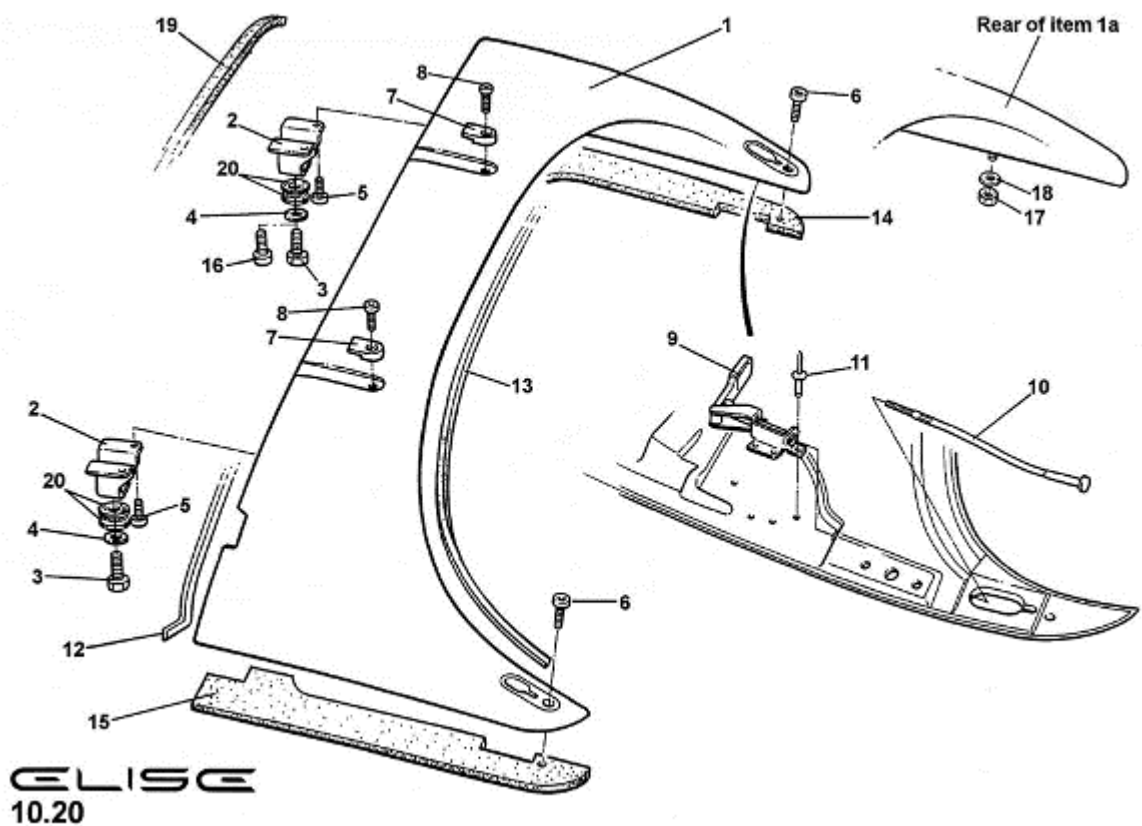

Eliseparts.com “S2 Longtail” Hardtop Fitting Instructions.

When you have removed your soft top you will also need to remove the two M6 bolts that secure the rear window shroud assembly to the clamshell, no.6 on the diagram below.



Preparing your Hardtop for installation.

Loosen the three bolts that secure the front roof panel to the hardtop, it is not necessary to remove the panel completely.

On each side of the front of the hardtop there are fixing brackets pre-installed; loosen the four bolts that secure them (just enough so the bracket can slide up and down); also remove the stainless steel pins.

Install the roof on the car by angling the front of the roof down, ensuring that the roof panel slips under the screen surround, then lower the rear of the roof in to place.

Re-install the stainless steel pins; they will secure in the same place as your soft top.

Screw them in enough so they start to pull the roof down, do not screw all the way in.

Before tightening the four screws on the fixing bracket, push down on the front corner of the roof so it sits flush with the screen surround; once you are happy tighten the four screws.

Check the alignment on the “tails” of your hardtop and install the stainless steel bolts provided in your fitting kit, you can adjust the roof forward or backwards by adjusting the stainless steel pins.

When you are 100% happy with the alignment of your hardtop, tighten the remaining fixings.

Fitting the side seals

We leave the seals slightly longer than required so they can be trimmed to the perfect length to your car; this is the best way to prevent water ingress.

When you have trimmed the seal to the correct length; use a solvent based cleaner to clean the appropriate area on the roof.

N.B. If you have just had the roof painted it will not be advisable to use a solvent based cleaner, just make sure the roof is clean and ideally not waxed which will prevent the seal from sticking.

Use a hair dryer to warm the seal and roof, this will help the adhesive tape to stick.

Install the seal in the desired position and check the window makes full contact, when you are happy, use both hands and work your way along the seal applying force to make sure it has adhered properly.

If your door glass requires adjustment, please refer to your service manual, section BP.10.

For further assistance you can email us at sales@eliseparts.com.